

Key:

EPDM Membrane	----
StrataPlan Detail Membrane	—
Hot Air Weld	////
StrataPlan GF Membrane	—
StrataPrime Fleeceback Adhesive	~~~~
StrataTherm Insulation	
StrataShield Air & Vapour Control Layer	- - - -

Construction Notes:

A strip of StrataPlan GF Membrane should be brought over the detail to finish below the sill. Alternatively, a StrataPlan Metal Angle can be utilised as indicated.

Mechanically fix the termination bar or StrataPlan Metal Angle at 150mm centres or as per the site specific wind-load location.

The sill should project min. 45mm over the terrace area with a drip min. 30mm away from the face of the upstand to shed water away from the interface with the waterproofing layer.

The system build-up and application should adhere to the STRATA issued specification.

All surfaces must be clean, dry, and suitably prepared to accept the waterproofing system.

All details should be installed in full compliance with the most up-to-date NHBC Standards, BS 6229, and STRATA recommendations.

Sill projecting min. 45mm with a min 30mm drip away from the face of the upstand.

Finished floor level

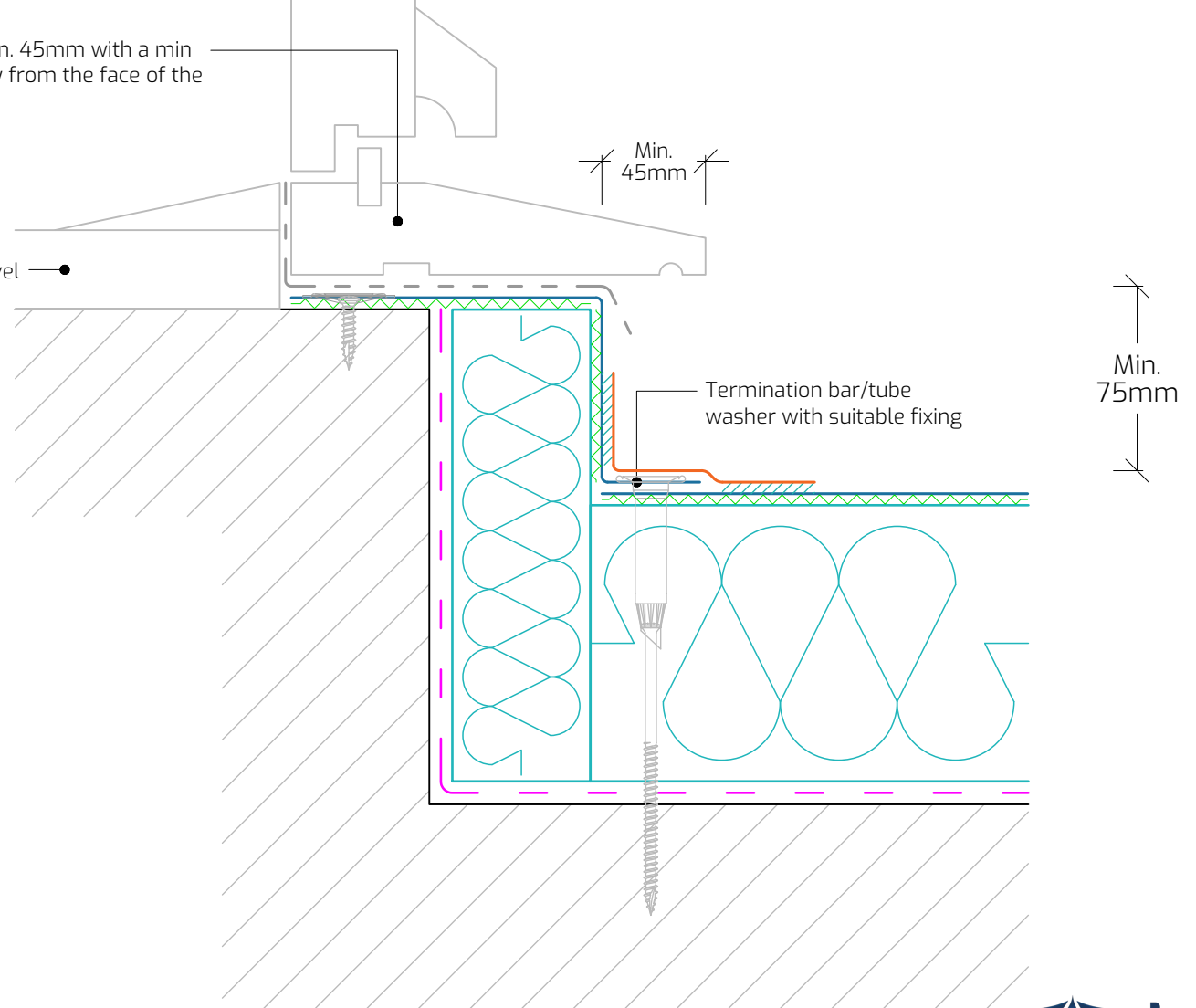
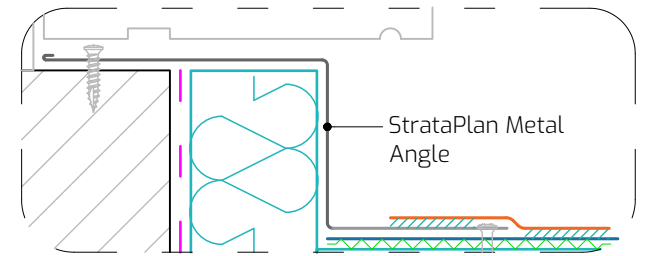
Alternative Detail

Drawing Title: Accessible Threshold

Drawing Number: SP-GF-W17

Scale: 1:3

Drawn By: E.V.

Date: 26/09/2025

T: 028 9030 2924 | E: technical@stratawaterproofing.com | W: www.stratawaterproofing.com

Copyright Reserved - Please note that this drawing and the copyright therein is the property of Strata Waterproofing Systems and is issued on the understanding that the drawing or any detail thereof will not be divulged to a third party unless written permission is first obtained from Strata Waterproofing Systems. The drawing is valid only when approved by the Architect / Contractor concerned.

This detail is representative of a typical situation and provided for illustration purposes. Insulation thickness shown may differ in accordance with the specified U-value requirement.

