

**Key:**

StrataBit Capsheet

StrataBase Underlay

Strata Angle Fillet

**Construction Notes:**

If required, use a timber board as a cavity closure on top of the parapet wall.

Use a strip of StrataBit Capsheet and StrataBase Underlay to bring up and over the parapet wall as indicated. Ensure all waterproofing terminates a min. 150mm above the finished roof level.

The coping stone should project a min. 45mm beyond the faces of the wall and incorporate a drip at least 30mm from the face of the wall to stop water running back under the coping.

Any upstand in excess of 250mm should be mechanically fixed at the leading edge with appropriate fasteners in order to avoid slippage of the waterproofing membrane.

The system build-up and application should adhere to the STRATA issued specification.

All surfaces must be clean, dry, and suitably prepared to accept the waterproofing system.

All details should be installed in full compliance with the most up-to-date NHBC Standards, BS 8217, BS 6229, and STRATA recommendations.

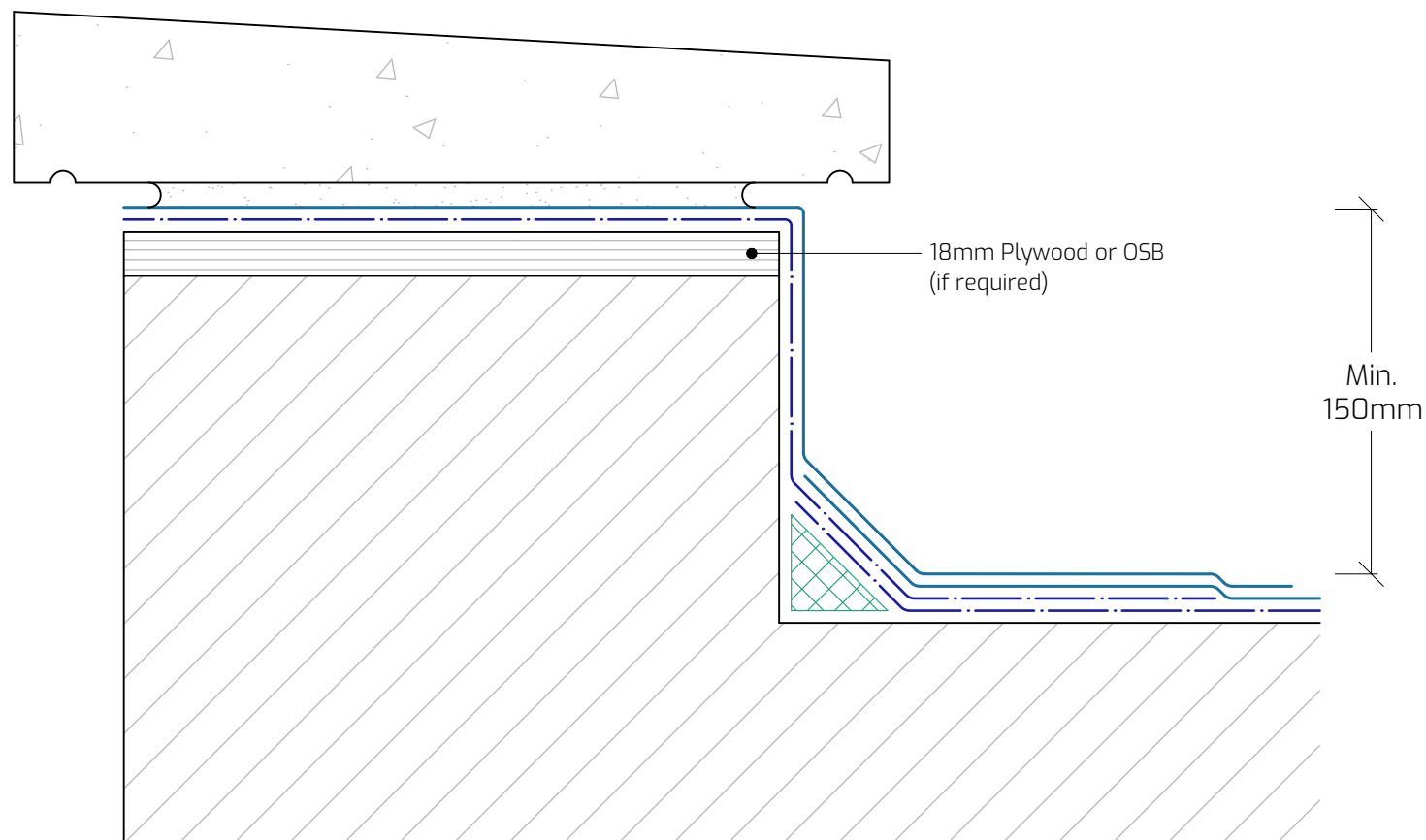
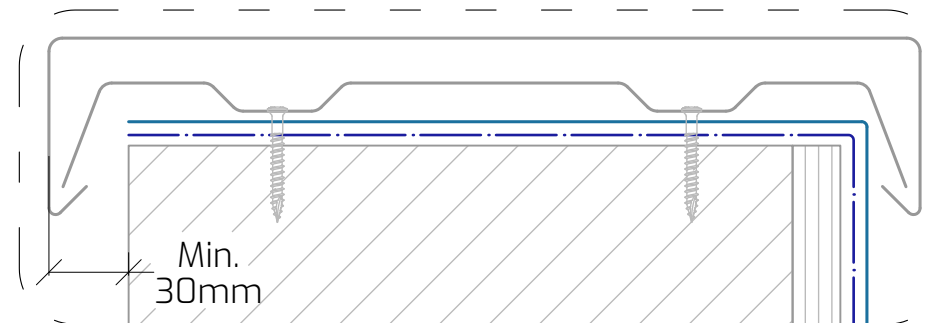
**Alternative Detail (NTS)****Drawing Title:** Parapet Wall With Coping**Drawing Number:** SB-TO-C15**Scale:** 1:3**Drawn By:** E.V.**Date:** 26/09/2025T: 028 9030 2924 | E: [technical@stratawaterproofing.com](mailto:technical@stratawaterproofing.com) | W: [www.stratawaterproofing.com](http://www.stratawaterproofing.com)

Copyright Reserved - Please note that this drawing and the copyright therein is the property of Strata Waterproofing Systems and is issued on the understanding that the drawing or any detail thereof will not be divulged to a third party unless written permission is first obtained from Strata Waterproofing Systems. The drawing is valid only when approved by the Architect / Contractor concerned.

This detail is representative of a typical situation and provided for illustration purposes. Insulation thickness shown may differ in accordance with the specified U-value requirement.