



TECHNOELAST

FIRE-SAFE FLAT ROOFING SYSTEMS WITH A 25-YEAR GUARANTEE



The TECHNOELAST range of high-performance roofing systems offers multi-layer waterproofing protection, exceptional fire performance and simple application, all supported by a 25-year insurance-backed guarantee.

With a choice of built-up systems, including torch-safe, torch-on and PU bonded options, there is a simple, cost-effective solution for all situations.

INDEPENDENT BBA APPROVAL

TECHNOELAST system membranes have been independently tested and awarded with BBA Certification. Key attributes that have been assessed and approved include performance in relation to weathertightness, fire protection and durability, along with resistance to wind uplift and foot traffic.



SYSTEM CHOICE FOR FREEDOM & FLEXIBILITY

TECHNOELAST systems provide specifiers and installing contractors with the ultimate choice of system type and most appropriate application method to suit individual project requirements.

The TECHNOELAST Torch-Safe System is ideal for combustible substrates. It incorporates a self-adhesive vapour control layer and underlay membrane, together with a high performance torch-on cap sheet for the ultimate combination of safety and performance. Alternatively, a full torch-on system can be specified, offering rapid installation and reliable waterproofing performance on non-combustible substrates.

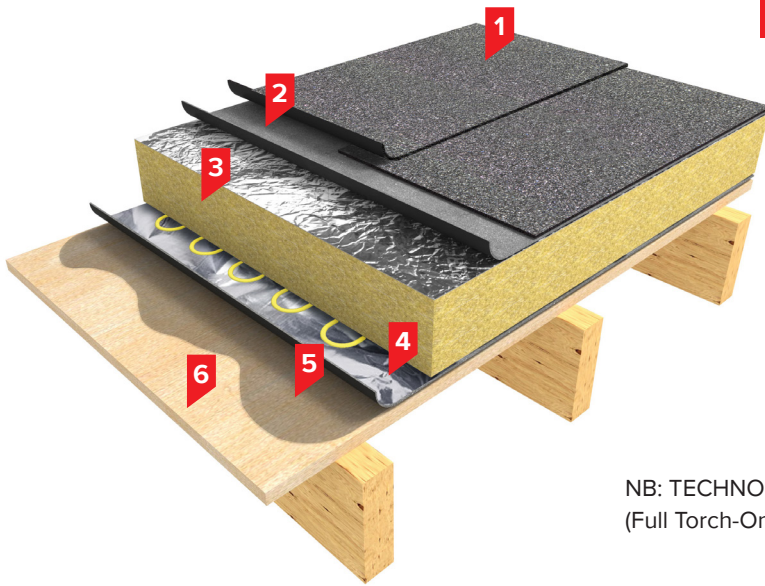

KEY BENEFITS OF TECHNOELAST

- Polymer modified coating providing flexibility and stability in a wide range of temperatures
- Unique snowflake printed thermofusible film to guide accurate and consistent torch-on application
- BBA Approved - Certificate Nos. 15/5275 & 15/5284
- Choice of system options, including torch-safe, torch-on and PU adhesive application
- Incorporates graphite firewall technology for the ultimate in fire protection
- Tested in accordance with the highest European fire safety standards

1. TECHNOELAST SBS or APP EKP Cap Sheet
2. MIDA SELF-ADHESIVE PV S2.0s Underlay
3. Foil-Faced Thermal Insulation (bonded with Sprayfix PU Insulation Adhesive)
4. TECHNOELAST VB 500 Self-Adhesive Vapour Control Layer
5. Sprayfix Self-Adhesive Primer
6. Substrate (e.g. timber deck)

NB: TECHNOELAST Torch-Safe System is depicted in illustration (Full Torch-On System options also available)



CONTROLLING CONDENSATION

TECHNOELAST VB 500 SELF is an aluminium lined, foil-faced, self-adhesive vapour control membrane which helps to effectively control condensation and ensure optimum performance of the system components. It also helps prevent decay of any timber within the roof build up and prevents corrosion of metal decking.

EXTENSIVE INDEPENDENT FIRE TESTING

TECHNOELAST membranes feature graphite firewall technology and have been fully fire tested in accordance with EN 13501-5 and ENV 1187:2002, Broof Test 4 (2-layer system).



NFRC
LEADING ROOFING EXCELLENCE

**Safe2
Torch**
REGISTERED